

BIOFLON NON LINED SWIVEL FLANGE FITTINGS

FLANGE SPECIFICATION

- ANSI B16.5 (also ASME B16.5) Class 150# and 300#
- *DIN PN10, PN16 and PN40
- JIS 10K
- Other Pressure Ratings and Flange Specifications are also available.

*DIN PN10, PN16 and PN40 Flanges all have the same dimensions, and so are fully interchangeable.



END FITTING MATERIALS

- Flanges in Grade 304 SS
- Flange Retainers in Grade 316L SS
- Ferrules, most in Grade 304 SS, some sizes in Grade 316L SS

PRESSURE RATINGS

- ANSI 150# = 230 psi (16 Bar), ANSI 300# = 460 psi (32 Bar).
- DIN PN10 = 145 psi (10 Bar), DIN PN16 = 230 psi (16 Bar), DIN PN40 = 580 psi (40 Bar).

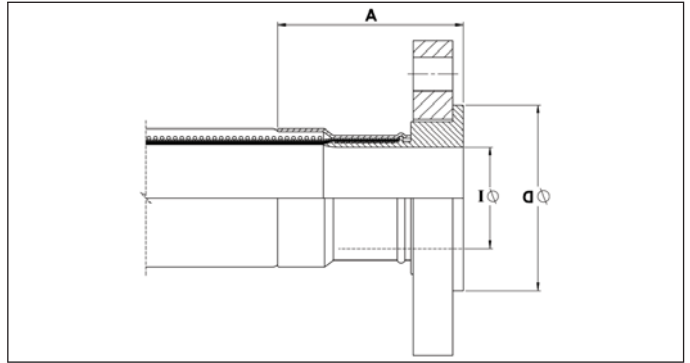

Nominal Hose Size		*Fitting Length A		Flared Diameter D				Fitting Inside Dia. and Hose Bore I	
				ANSI 150#		**DIN PN10/16/40			
in	mm	in	mm	in	mm	in	mm	in	mm
2½	65.0	4.0	101	4.13	105	4.81	122	2¼	57.1
3	80.0	4.1	104	5.00	127	5.44	138	2⅝	66.7

BIOFLON NPT AND BSPT FIXED MALE AND NPT FIXED FEMALE FITTINGS

End Fitting Specification

NPT Taper Threads to American National Standard Pipe Taper Thread design to ANSI/AMSE B1.20.1.

BSPT Threads to British Standard Pipe Taper Thread design to BS21.

End Fitting Materials

- Fittings in Grade 304 SS
- Ferrules, most in Grade 304 SS, some sizes in Grade 316L SS
- Alternatives - Fittings in Zinc Plated Carbon Steel

Fixed Male NPT or BSPT

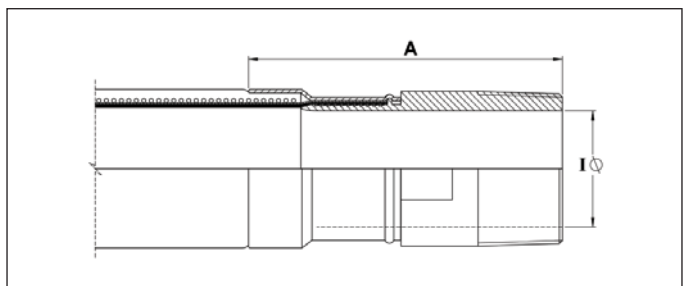

Nominal Hose Size		NPT or BSPT Thread Size	*Fitting Length A		Fitting Inside Diameter I	
in	mm	in	in	mm	in	mm
2½	65.0	2½	4.0	101	2¼	57.1
3	80.0	3	4.3	110	2⅝	66.7